

## Idle Isle Park (W182 S6666 Hardtke Dr.)

Picnicking, boat launch, (18) car/boat trailer parking facilities, handicap accessible fishing pier, swimming and other recreational features. Attendant on duty weekends Memorial Weekend through Labor Day. There will be no lifeguards on duty. Swim at your own risk.

### PARK HOURS--5:00 AM-10:00 PM

#### PARKING FEES:

\$1.00 Monday through 5:00 PM on Friday  
\$4.00 Friday 5:00 PM through Sunday & holidays

#### LAUNCHING: \$7.00 Daily Fee (per trailer)

Launching fees must be paid at all times, even when no attendant is present. New parking pay stations will be located at Idle Isle starting in 2018 for collection of daily fees. Or a season launch pass must be affixed to windshield to show notice of payment. Failure to comply with launch payment will result in a citation.

## Launch Fees for 2018

Those using a boat launch are required to pay a launch fee **every time** they use the launch. This includes the city maintained launches at:

- Little Muskego Lake:  
Idle Isle, Hillview, Oak Court, Pleasantview
- Big Muskego Lake  
Durham, Boxhorn
- Denoon Lake  
Denoon Park

A launch is considered anytime a trailered watercraft is put into the water where the tires of the trailer enter the launch and then the water. If you are using the launch only with a watercraft you have carried into the water (i.e. kayak, stand-up paddleboard) you do not have to pay the launching fee.

This fee must be paid even if you live on the lake and please note, your property taxes do not cover the launch fees. Launch fees are collected at the direction of the DNR and are used for improvements on that launch. **Failure to comply with launch payment will result in a citation.**

Each launch has an honor box with receipt envelopes which must be fully completed and payment enclosed and placed in the honor box. Receipt of payment should then be placed in the vehicle window. You can use these same envelopes to order your season pass or you can stop by the City Hall during normal business hours to purchase a pass.

**SEASON** City Residents **\$42.00**  
**PASSES** City Senior Resident, 60+ Years **\$14.00**  
Non-city Residents, any age **\$63.00**

**NOTE:** A second pass may be purchased at half-price for the same boat/trailer/owner and must be purchased at the same time the first pass is being purchased.

## Park Shelter Rentals

All clubs/associations, groups or affiliations wishing to use a facility must complete the Application Form for Use of Park Buildings/Shelters available at the Recreation Department or from the website. Having a permit allows you to have exclusive access to the shelter. Also, having your event in our reservation book helps us with planning maintenance and other park events that are scheduled.

Due to increased demand of the parks, a rental limit of 6 hours is used. Rental hours are 8:30 a.m.-2:30 p.m. OR 3:00 p.m.-9:00 p.m. You can rent for the full day, but you will be paying for both rental slots. This does not include Denoon and Manchester shelters, which only have portable toilets.

- BLUHM
  - MANCHESTER HILL
  - VETERANS MEMORIAL
  - DENOON
  - PARK ARTHUR
  - \*\*IDLE ISLE\*\*
- \*\*Idle Isle - Available Monday-Thursday only, no holidays.

Adults/Families	Residents	Non-resident
1-75 persons	\$75.00	\$100.00
76-150 persons	\$100.00	\$125.00
151-200 persons	\$150.00	\$175.00
Youth/Non-profit for weekend use	Residents	Non-resident
1-75 persons	\$50.00	\$100.00
76-150 persons	\$75.00	\$125.00
151-200 persons	\$125.00	\$175.00
Youth/Non-profit for weekday use	Residents	Non-resident
1-49 persons	\$15.00	\$25.00
50-100 persons	\$30.00	\$45.00
100+ persons	\$50.00	\$75.00

### OLD TOWN HALL

Due to the use of the upper level of the Old Town Hall for recreational programming, we will not be renting out the upper level in 2018.

Lower level may be rented through the Muskego Historical Society.

## Beer Permit Policy

City ordinance stipulates that the consumption of beer will be allowed in any city park by permit only. A permit must be obtained at the Recreation Department office during regular office hours at **least one complete week prior to the date requested for usage**. Permit applications must be filed in person as age must be verified by valid operator's license, Wisconsin I.D. card, or birth certificate.

#### BEER PERMIT FEE/DATE

Resident: \$5.00 Non-resident: \$15.00

# Park Information

## Annual Park Operations Timetable

-Restrooms open May 1 with closure on September 30 for Idle Isle, Lions, Kurth, Bluhm Farm and Veterans Memorial Park. Park Arthur restrooms open year-round.

-Docks and fishing piers are installed the first weekend in May. Little Muskego will be dependent on the lake re-filling.

-Idle Isle staff on duty weekends and holidays beginning when the lake refills through Labor Day.

-Swimming lines at Idle Isle Park beach will be in when lake is refilled.

-Tennis/Pickleball nets are installed in April.

-Pre-season field maintenance will begin no earlier than April 15 to have the baseball/softball fields ready for use on May 1.

-Baseball/Softball fields will be released for league practices and play on May 1. No use league use will be allowed until that day.

-Ballfields/Soccer/Football/Rugby fields will be sprayed in both early spring and fall for weeds. All fields will be closed for use after spraying for the required time of application. Leagues will be notified of the spraying 2 weeks prior to the date so schedules can be modified.

-League requests for field use should be submitted no later than January 15 for baseball/softball, March 1 for spring soccer and rugby, July 1 for football and fall rugby, and August 1 for fall soccer. League applications can be found online.



## Free Wood Chips

Wood chips and compost are available to city residents **FREE** of charge year-round. The chips & compost are located on the Municipal Garage property at the west-end of Saturn Drive in the City of Muskego Industrial Park.



Please remember not to feed or harass wildlife. Please respect our wildlife that are present in our parks. Thank you.

## Stop the Vandalism

Abuse and vandalism of your community and neighborhood parks and facilities is a serious problem. Problems concerning vandalism can be costly and time-consuming process to correct. If you witness acts of vandalism or the results of such acts, please contact the Public Works Department at **1-262-679-4128** or the Muskego Police Department at **1-262-679-4130**. Have pride in your parks and facilities, and please show community support to prevent vandalism!

## City Tennis Courts

Residents of Muskego may reserve tennis courts as soon as nets are up. Reservations for courts will only be issued at the Recreation Department office during normal business hours. There will be a \$1.00 fee per date/court charge for this reservation. You must have proof of Muskego residency to reserve a court. Leagues and organized groups must make special arrangements with the department. Individuals may reserve one court for one hour and it must be at least 24 hours in advance of the time reserved. Your reservation will give you priority to use one court for one hour. All tennis players must observe this permit. There will be no attendants on duty.

### Location of Courts:

**Kurth Park, Schmidt Park and Freedom Square**

## Equipment Rental

The Recreation Department has available for daily rental: kayaks, stand-up paddleboards, paddles and life jackets.

Rental of these items must be made at least one week in advance from the date of use. You must complete a rental application, sign and waiver and make payment at the Recreation Department office inside city hall.

You can rent the items for use at Idle Isle Park or you can personally transport them to either Denoon or Big Muskego Lakes. The equipment cannot leave the city.

For more information or request a date, please call the office at 262-679-4108.

## City of Muskego Department Directory

### CITY'S WEB PAGE

[www.cityofmuskego.org](http://www.cityofmuskego.org)

### CITY DEPARTMENTS

CITY HALL INFORMATION.....	679-4100
CITY HALL FAX.....	679-4106
Assessor's Office.....	679-4143
Clerk-Treasurer's Office.....	679-5625
Engineering.....	679-4145
Finance Department.....	679-5622
Library.....	971-2100
Mayor's Office.....	679-5675
Municipal Court.....	679-4114
Municipal Garage.....	679-4128
Parks & Recreation .....	679-4108
Community Development Department.....	679-4136
Police Department Non-emergency.....	679-4130
Recreation 24-Hr. Hotline/Information.....	679-5645
Refuse/Recycling.....	679-4128
Sewer Utility Billing & Special Assessments.....	679-4128
Taxes.....	679-5627
Advanced Disposal Special Curb Pick-ups.....	679-0860
Voter Registration.....	679-5628
Water Utility Billing & Special Assessments.....	679-4128
Hearing Impaired TDD Line.....	679-4103

**EMERGENCY 9-1-1**

## Poll Workers Needed 2018-19

The City Clerk's office is seeking applicants who are interested in becoming involved in the election process to serve as Election Day poll workers. Applicants will be asked to work in one of seven polling locations, assisting the Chief Inspectors in performing election duties.

Duties include issuing ballots to registered voters, registering voters, monitoring the voting equipment, explaining how to mark ballots and use the voting equipment, processing absentee ballots and gathering forms/equipment after the polls close. Applicants will be provided paid training by the City Clerk's office as well as compensation for each election worked.

If you are interested please visit:  
[cityofmuskego.org/government/employment](http://cityofmuskego.org/government/employment)  
or call the clerk's office at 262-679-5628.

**2018 Election Dates:**  
**Fall Primary, August 14th**  
**Fall Election, November 6th**

## OPDMD Usage of Muskego Recreation Trails

Because of the high number of trail users (factor II) with multi-use activities occurring on our trail system and while allowing for safe passing (factor IV) from both directions and overall safe usages on our 8' wide asphalt/stone trails, allowable OPDMD's (only for persons with mobility disabilities) should not be wider than 32" and for the safety of all users, all trail users shall observe a not-to-exceed-a 5 miles per hour speed limit (factor I) on all park trails. Also, per the city's trail agreement lease with WeEnergies, they have determined that for safety reasons (factor IV) there are "no motorized recreational vehicles, including but not limited to snowmobiles, motor bikes, mini-bikes, motor cycles, mopeds, go-carts, and all terrain vehicles will be used, operated, or permitted on the license premises. Licensee/Licenser (City/WeEnergies) shall have the right to use motorized vehicles for patrol and maintenance of the right-of-way lands used for hiking, biking, and cross-country ski trails."

## Equestrian Usage

Horses are allowed on the Park Arthur equestrian trail, Highway 36 recreation trail between Highway OO and Racine County Line and also We-Energies trail from Woods Road to Big Bend village limits. Please follow these rules when using this dual-use trail.

- Be acutely aware of hikers and bikers.
- Keep horses on the designated trails.
- When possible, ride on the shoulder of the trails.
- Horses should be ridden at a controlled speed at all times.
- Riders should follow the rules of the road—stay on the right side of the trails.
- All pets accompanying horse and rider should be leashed and under control
- Clean up after your horse/pet.

## Adopt-A-Park, Trail or Lake Access Program

This program is to provide trash clean up in a local park, trail or lake access twice a year on an ongoing basis. Individuals, groups, and companies interested in participating are invited to call the Muskego Parks & Recreation Department at 262-679-4108. Signs are erected crediting the involved citizens.

## The City of Muskego has declared the month of May as Green-up Muskego.

The Green-up Muskego theme emphasizes cleaning the city and county right-of-ways and asks residents that they clean the right-of-way adjacent to their property.

# Muskego Park & Trail Map

The table listed on page 57 details the park facilities at each of the existing park sites in Muskego. For more detailed identification of each location, please refer to the map or visit the City's maps program at: <http://www.mapmuskego.com/mapTRAILS/>

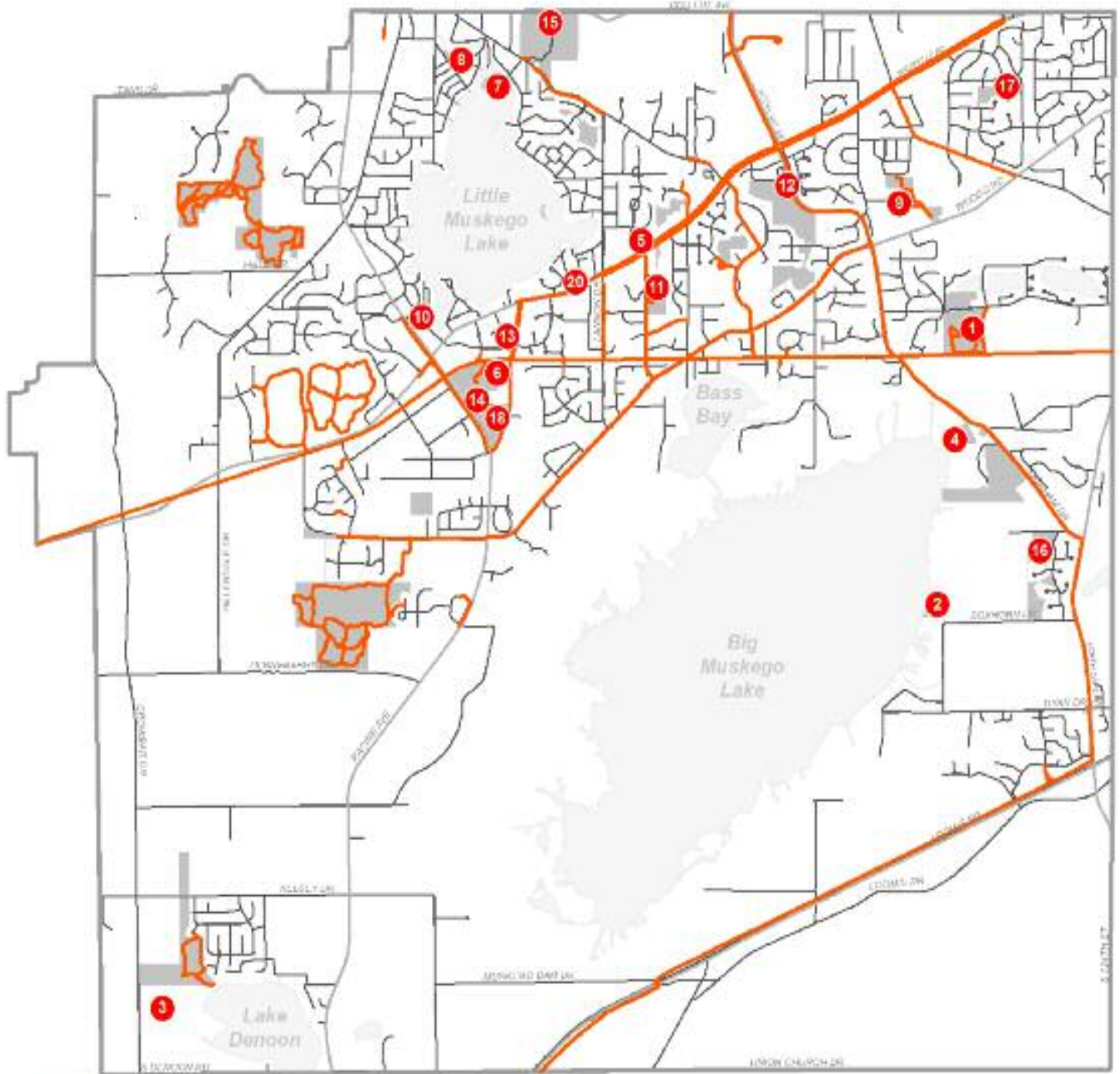

- Public Park Location
- Existing Recreation Trail
- Roadways
- Water Boundaries
- Parks

The recreation trail can be utilized for the following activities only:  
\*Hiking \*Jogging \*Non-motorized Biking \*Cross-country skiing

The Muskego Park and Recreation Board envisions a community linked together by a system of safe and functional off-road recreation trails.

Please remember to clean up after your dogs/horses and maintain control of your dog with a leash no longer than 10 feet. This will ensure that all trail users will have a great time. Thank you for your cooperation.

# Parks & Facilities



	Acreeage	Archery	Baseball/Softball Field	Basketball Goals	Boat Launch	Fishing	Ice Rink	Informal Sports Field	Memorial/Historical	Picnic Area	Playground	Restrooms/Portable	Shelter	Skateboarding	Sledding Hill	Soccer Field	Swimming Beach	Tennis/Pickleball Courts	Walking Trails
<b>1. Bluhm Farm Park</b> S77W13607 McShane Dr	50.0		•	•						•	•	•	•						•
<b>2. Boxhorn Launch</b> S90W13976 Boxhorn Dr.					•	•						•							
<b>3. Denoon Park</b> W216S10798 Crowbar Dr.	53.0		•	•	•					•	•	•	•			•			•
<b>4. Durham Launch</b> S82W13783 Durham Dr.					•	•						•							
<b>5. Freedom Square</b> Parkland & Janesville	.5			•															<b>T</b>
<b>6. Horn Field (Park)</b> S79W18200 Horn Park Dr.	11.8		•						•		•	•							
<b>7. Idle Isle Park</b> W182S6666 Hardtke Dr.	7.0				•	•				•	•	•	•				•		
<b>8. Jensen/Lee Hubka Park</b> W185S6599 Agate Dr.	3.5		•	•							•	•							
<b>9. Kurth Park</b> S70W14415 Belmont Dr.	17.5		•	•							•	•				•		<b>T</b>	•
<b>10. Lions Park</b> S77W18950 Lions Park Dr.	3.5			•				•			•	•						<b>P</b>	
<b>11. Manchester Hill Park</b> W167S7650 Parkland Dr.	15.5						•			•	•	•	•			•			
<b>12. Moorland Park</b> W154S7105 Moorland Rd.	37.0										•	•		•		•			
<b>13. Historic Muskego Centre</b> W180S7795 Pioneer Dr.	.25								•										
<b>14. Old Settlement Centre</b> W184S8074 Racine Ave.	8.0								•										•
<b>15. Park Arthur</b> S63W17833 College Ave.	46.0	•	•							•		•	•	•	•				•
<b>16. Sand Hill Park</b> S87W13053 Priegel Dr.	19							•		•	•	•	•		•				•
<b>17. Schmidt Park</b> S67W13660 Fleetwood Dr.	6.5			•				•			•							<b>T</b>	•
<b>18. Veterans Memorial</b> W182S8200 Racine Ave.	1.0									•	•	•	•						•

# Park Information

## Denoon Park Disc Golf Course - New Park Amenity

The first part of the process began with the 2017-2021 Parks and Conservation Plan which listed a disc golf course as one of their recommendations. The project was brought forward to the Council with the 2017 capital budget and it was approved. Once approved for construction in 2017, the city began working with Mike Harrington from The Disc Golf Experience to design a new 9 hole course that will meander through Denoon Park. Once design of the course was completed, the Department of Public Works crew began the task of clearing brush and trees and cut back some prairie areas for the course to be constructed. The course will flow from the parking lot thru the prairie, past the playground, around through the trail areas and back across the road leading to the boat launch. The course is designed to take people throughout the park and provide a challenging disc golf encounter. Course designer Mike Harrington describes the course as such: "Denoon Park Disc Golf Course is beginner friendly but still has some challenging features to keep the avid player interested. This course is very balanced in the type of shot you need to throw including a nice variety of up-hill and down-hill holes. There are holes where you need to throw straight, some that turn left to right and others that require you to throw right to left, and many of the holes have many options on how to get closest to the basket. The topography is rolling hills and the foliage varies from wooded to open. It starts with 5 wooded holes and finishes with 4 holes that are set in the prairie with some brush and a handful of trees to contend with. The 9th hole is played as an Island hole where the "Green Area" will be a mulched area and any drive landing outside of the mulched area will be considered Out of Bounds.

### Course Layout

Hole #1 starts north of the boat launch road heading east.

Walk up the hill and cross the road to find #2 tee. #2 heads back west.

#3 tee is near the road throwing South-west towards #4 tee.

#4 heads back north across a small stream to a grassy opening between larger trees.

Walk across the parking lot to the #5 tee located close to the guardrail and head north along the dense brushline.

Then cross the gravel walking path to tee #6 and throw towards the massive Willow Tree to the Northwest.

Cross the gravel walking path again and find the #7 tee against the brush along the western property line throwing south.

Walk past the playground area to the east and find #8 tee located behind three smaller Oak trees throwing south.

#9 tee is just a short walk to the west throwing to the island green located near the large apple tree.

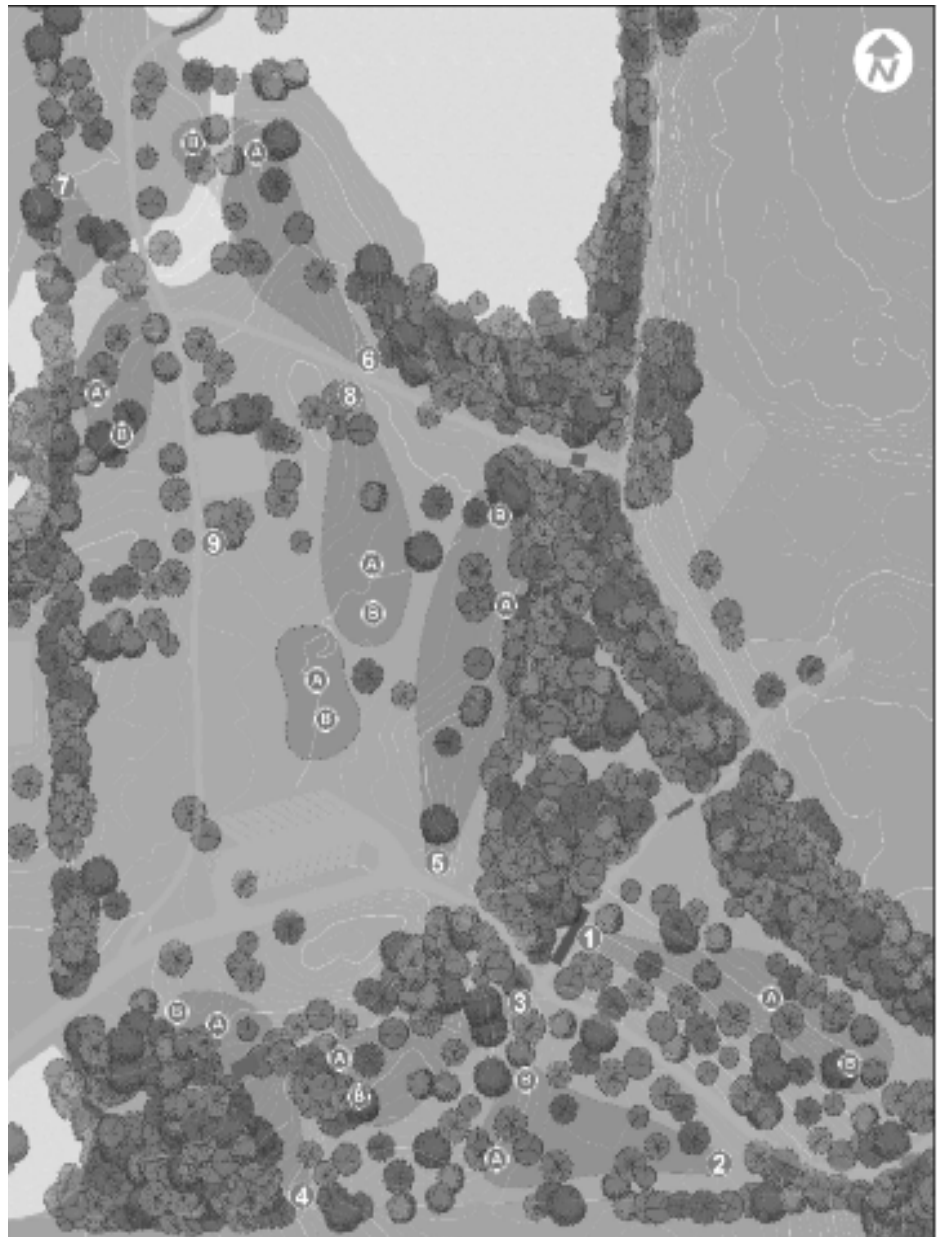

## Sand Hill Park - Playground and Shelter

The City's newest park is located at S87W13053 Priegel Drive in the Aster Hills Estates subdivision. The new park includes an uniquely designed playground with a rubber flooring and play pieces for children ages 2-5 and 5-12, a new open air shelter, open turf areas, an area for sledding in the winter and conservation trail connections to other Muskego and Wisconsin DNR conservations areas to the south of the park. Sand Hill Park includes 5.8 acres of conservation land that includes wetlands and a prairie/savanna planting in a former agricultural field adjacent to Blattner Conservation site. Blattner Conservation Site contains a rare oak savanna and includes hickory trees as well.

A trip to this park and conservation areas will allow visitors to see Muskego as the first settlers did.



## Idle Isle Pay Stations



Beginning Spring 2018 the city will be utilizing pay stations at Idle Isle Park for collecting both launching and parking fees. There will be two pay stations located within the park to collect fees. The first machine will be located by the parking area near the dumpster. The fee for parking will be \$ **\$ 1.00 Mondays through 5:00 PM on Friday AND \$ 4.00 Friday beginning 5:00 PM through close of the park on Sunday and on holidays.** Parking fees will be collected at all times. Failure to pay parking fees will result in a citation. The second pay station will be located by the launch area. At this pay station you will be able to pay your daily launching fee of \$7.00.

At both pay stations, payment can be made via cash, change or credit card. Once payment is made, a receipt will print out that you will then place on your dash. Muskego Police Officers will be able to verify payments made on the pay station and will issue citations to those who have not paid the appropriate fees while parked in the parking lot or launch area.

For those who have purchased a season pass for launching their watercraft, the pass must be affixed to the windshield of the towing vehicle in order to avoid a citation.

## Disc Golf Season Pass

Beginning May 2018, the Recreation Department will begin selling an annual season pass for the new disc golf course at Denoon Park. A pass is not required for use of the course, but will allow those with a pass the right to consume beer while on the course. City ordinance requires anyone in a city park who is consuming beer to obtain a permit at least 5 business days before use. This pass will cover the passholder to consume beer in the park until December 31st.

The cost of season pass will be \$25.00 and will be good from the day of purchase through the end of the year. Pass must be carried at all time when on the course and is only good for the name on the card. Season passes can only be purchased at the Recreation Department office located in City Hall. Office hours are 8:00 a.m. to 4:30 p.m., Mon.-Fri.

Those not wishing to purchase a pass can still obtain a beer permit by stopping at the Recreation Department office and completing a beer permit form and paying the required fee of \$5.00/resident or \$15.00/non-resident per date of use.